

MITEK IO LINK



ADVANTAGES

- *Automatically counts trusses made in OptiFlow.*
- *Automates various functions in MiTek OptiFlow.*
- *Improves quality of truss manufacturing data.*
- *Six switch inputs.*
- *Various electrical switch styles catered for.*
- *Suits all truss manufacturing equipment.*
- *Powered by 12 to 24V DC.*
- *USB connection to host PC.*



creating the **advantage**

MITEK IO LINK

Description:

The MiTek IO Link is designed as an 'add on' to MiTek OptiFlow software. It is designed to connect up to six (6) physical inputs/switches to a PC via a simulated keystroke. The IO Link software then converts the simulated keystroke input to the actual keyboard stroke required to actuate an OptiFlow function.

IO Link's primary purpose is to automate common keyboard inputs strokes to the MiTek OptiFlow software, therefore increasing productivity and more importantly, the accuracy of your truss plants production feedback.

Features:

- Quick and easy setup.
- Flexible configuration of input styles.
- Can be installed without an electrician.
- Comprehensive manual supplied (on CD).

Specifications:

- 24V Power Supply (Plug pack included)
- USB Connection to PC (lead included)
- Six (6) NPN inputs
- 24V, 1 Amp output power supply (used to power external sensors if required)

Software:

- MiTek IO Link software is designed to work with the following MiTek applications:
 - OptiFlow
 - Planx Link (Matchpoint Planx)
 - VL Link
 - SL Link

Application Examples:

- Counts 'Truss Made' on truss ejection on roller press.
- Remote buttons for next truss & previous truss.
- Remote buttons for setting pucks on MiTek Planx.
- Remote buttons for adding a truss to a Virtek laser system.

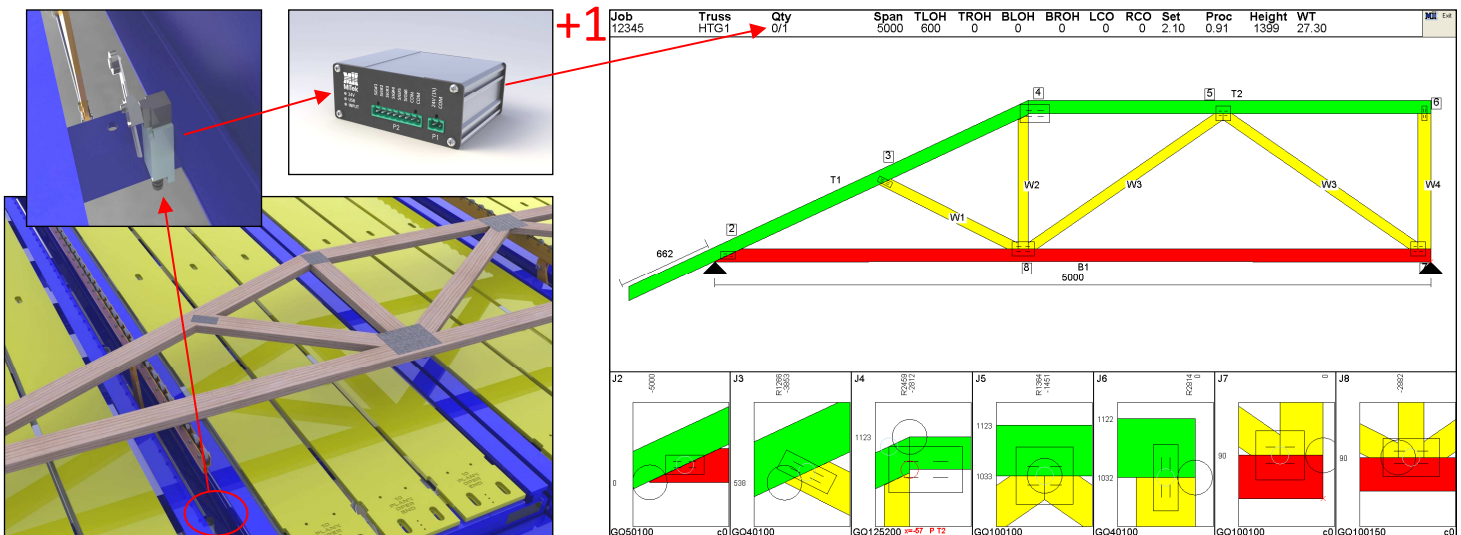

MiTek Australia Ltd.

ABN 98 004 564 857
 46 Monash Drive Dandenong South
 Victoria 3175 Australia
 Telephone 03 8795 8888
 Facsimile 03 9702 9464
 Web Site www.mitek.com.au

New South Wales 02 9609 8700
 Queensland 07 3861 2100
 South Australia 08 8234 1326
 Western Australia 08 9412 3534
 New Zealand 09 274 7109
 Malaysia 603 3176 7473



creating the advantage